

EN 1092-1 PN2.5 Flanges

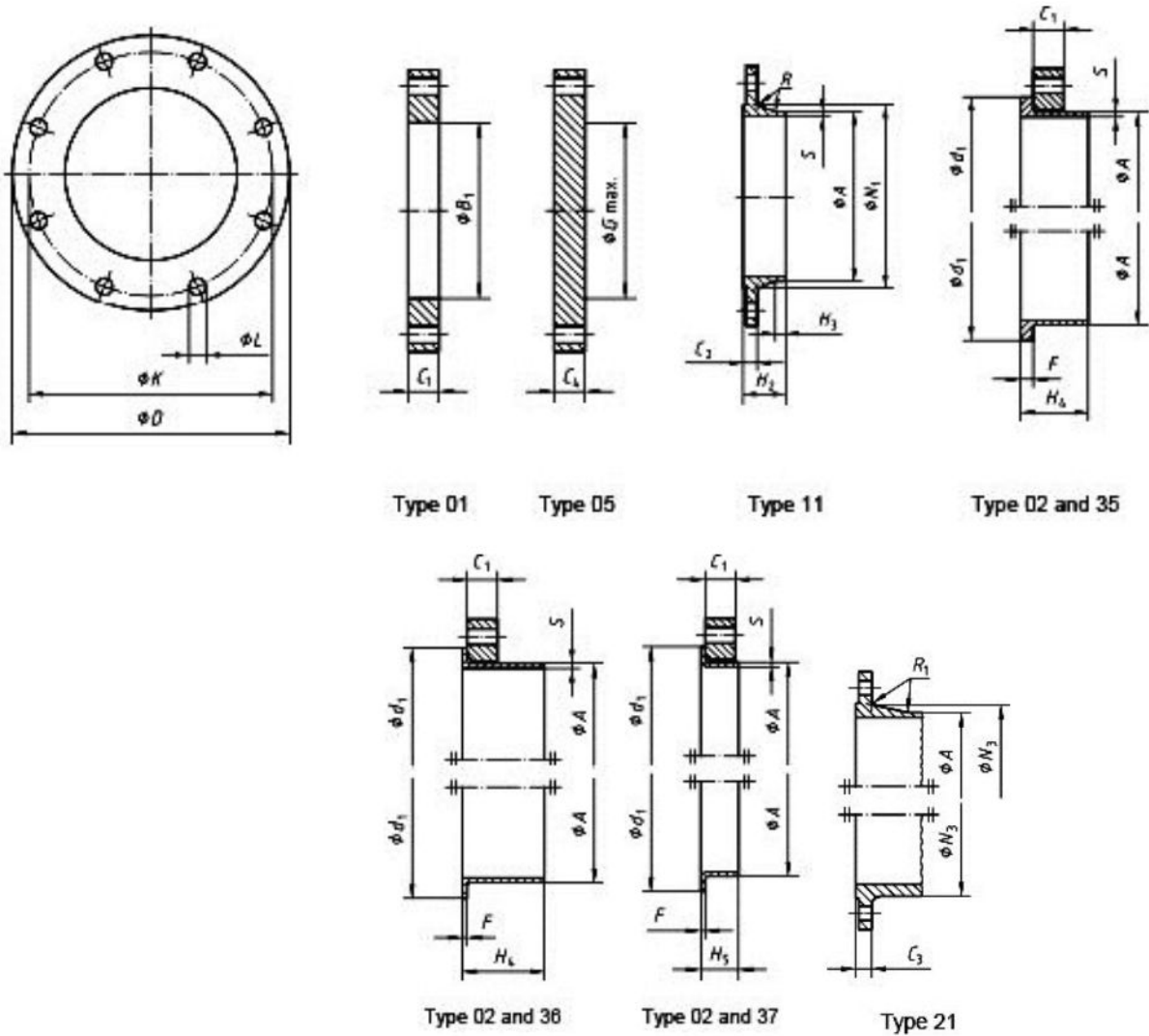

Flange type (typ) as in EN 1092-1	
01 (Plate [slip-on] flanges for welding)	21 (Integral flanges)
02 (Loose plate flanges with weld-on plate collar)	35 (Welding neck)
05 (Blank [blind] flanges)	36 (Pressed collar with long neck)
11 (Weld-neck flanges)	37 (Pressed collar)