

KF Flanges & Components

Dimension (mm)

90° Elbows – USA

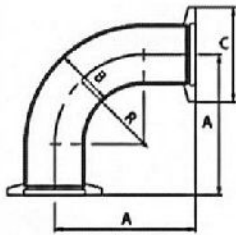

Model No.	A	B	C	R
E90A-16	38.3	19.05	30	28.6
E90A-25	56.2	25.4	40	38.1
E90A-40	78.4	38.1	55	57.2
E90A-50	107.0	50.8	75	76.2

90° Elbows – Europe

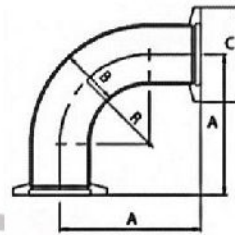

Model No.	A	B	C	R
E90E-16	40.0	19.05	30	28.6
E90E-25	50.8	25.4	40	38.1
E90E-40	65.0	38.1	55	57.2
E90E-50	80.0	50.8	75	76.2

Tees – USA

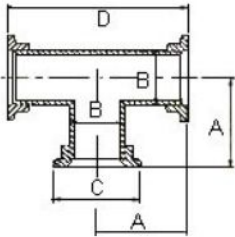

Model No.	A	B	C	D
TA-16	38.3	19.05	30	76.6
TA-25	51.4	25.4	40	102.8
TA-40	61.0	38.1	55	122.0
TA-50	80.0	50.8	75	160.0

Tees – Europe

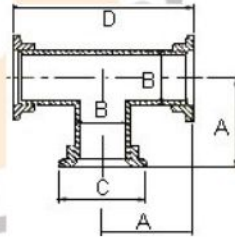

Model No.	A	B	C	D
TE-16	40	19.05	30	80
TE-25	50	25.4	40	100
TE-40	65	38.1	55	130
TE-50	70	50.8	75	140

Unequal Tees – USA

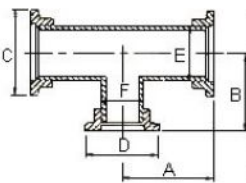

Model No.	A	B	C	D	E	F
UTA25-16	51.8	37.3	40	30	25.4	19.05
UTA40-16	62.5	51.8	55	30	38.1	19.05
UTA40-25	62.5	61.0	55	40	38.1	25.40
UTA50-16	81.5	58.2	75	30	50.8	19.05
UTA50-25	81.5	72.1	75	40	50.8	25.40
UTA50-40	81.5	70.0	75	55	50.8	38.10

Unequal Tees – Europe

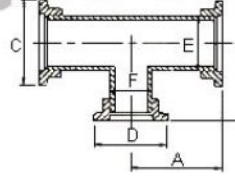

Model No.	A	B	C	D	E	F
UTE25-16	60	40	40	30	25.4	19.05
UTE40-16	65	40	55	30	38.1	19.05
UTE40-25	65	50	55	40	38.1	25.40
UTE50-16	70	50	75	30	50.8	19.05
UTE50-25	70	65	75	40	50.8	25.40
UTE50-40	70	65	75	55	50.8	38.10

KF 4-Way Crosses – USA

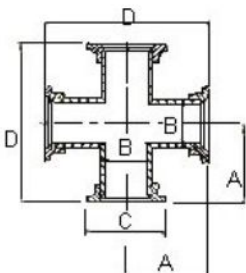

Model No.	A	B	C	D
4CA-16	38.3	19.05	30	76.6
4CA-25	51.4	25.4	40	102.8
4CA-40	61.0	38.1	55	122.0
4CA-50	80.0	50.8	75	160.0

KF 4-Way Crosses – Europe

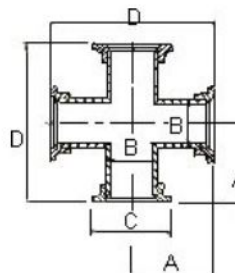

Model No.	A	B	C	D
4CE-16	40	19.05	30	80
4CE-25	50	25.4	40	100
4CE-40	65	38.1	55	130
4CE-50	70	50.8	75	140