

Globe Valve Class 600

Features

1. Thread ends: NPT, BSPP, BSPF, BSPT, PT
2. Investment casting

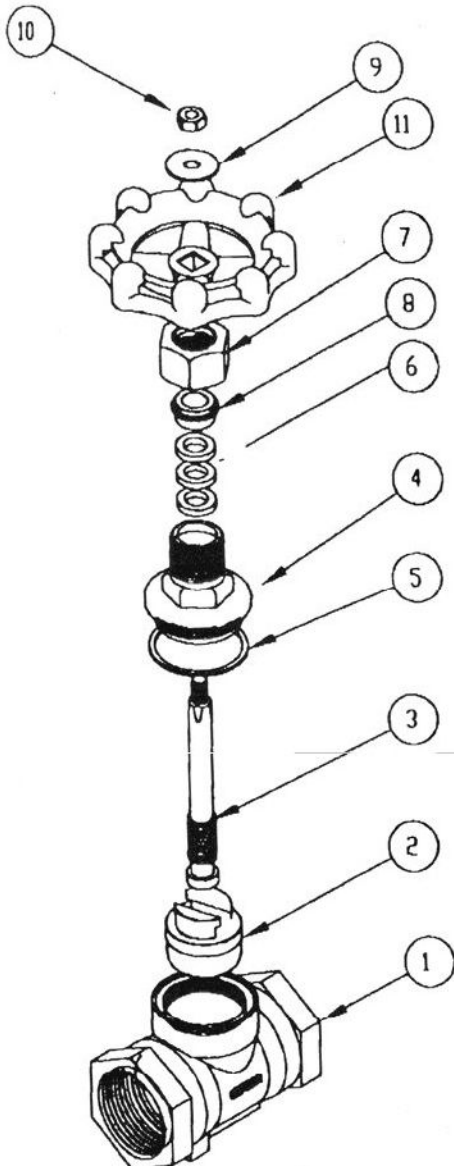

Delta INC

Material List

| NO. | PART NAME | MATERIAL |
|-----|--------------|----------------|
| 1 | BODY | 304, 316, CF8M |
| 2 | DISC | 304, 316, CF8M |
| 3 | STEM | 304, 316 |
| 4 | CAP | 304, 316, CF8M |
| 5 | GASKET | TEFLON |
| 6 | PACKING | TEFLON |
| 7 | CAP NUT | 304, 316, CF8M |
| 8 | GLAND WASHER | 304 |
| 9 | SPIN WASHER | 304 |
| 10 | NUT | 304 |
| 11 | HANDLE | DUCT IRON |

Dimensio

| SIZE | 1/4" | 3/8" | 1/2" | 3/4" | 1" | 1-1/4" | 1-1/2" | 2" |
|--------|------|------|------|------|-----|--------|--------|-----|
| L (mm) | 63 | 63 | 63 | 70 | 77 | 87 | 100 | 110 |
| H (mm) | 105 | 105 | 106 | 106 | 116 | 122 | 144 | 145 |
| D (mm) | 62 | 62 | 62 | 62 | 75 | 75 | 95 | 95 |