

Reducing Coupling Threaded

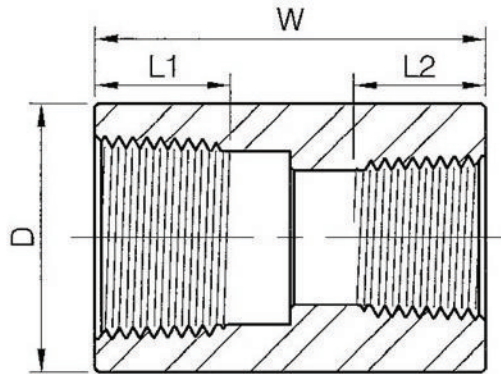

Nom. Pipe Size	D		W	L1	L2
	3000Lb	6000Lb			
1/4"x1/8"	19.0	25.0	35.0	11.4	8.8
3/8"x1/8"	22.0	32.0	38.0	12.4	8.8
3/8"x1/4"	22.0	32.0	38.0	12.4	11.4
1/2"x1/8"	28.0	38.0	48.0	14.9	8.8
1/2"x1/4"	28.0	38.0	48.0	14.9	11.4
1/2"x3/8"	28.0	38.0	48.0	14.9	12.4
3/4"x1/8"	35.0	44.0	51.0	16.8	8.8
3/4"x1/4"	35.0	44.0	51.0	16.8	11.4
3/4"x3/8"	35.0	44.0	51.0	16.8	12.4
3/4"x1/2"	35.0	44.0	51.0	16.8	14.9
1"x1/8"	44.0	57.0	60.0	19.6	8.8
1"x1/4"	44.0	57.0	60.0	19.6	11.4
1"x3/8"	44.0	57.0	60.0	19.6	12.4
1"x1/2"	44.0	57.0	60.0	19.6	14.9
1"x3/4"	44.0	57.0	60.0	19.6	16.8
1-1/4"x1/8"	57.0	64.0	67.0	21.9	8.8
1-1/4"x1/4"	57.0	64.0	67.0	21.9	11.4
1-1/4"x3/8"	57.0	64.0	67.0	21.9	12.4
1-1/4"x1/2"	57.0	64.0	67.0	21.9	14.9
1-1/4"x3/4"	57.0	64.0	67.0	21.9	16.8
1-1/4"x1"	57.0	64.0	67.0	21.9	19.6
1-1/2"x1/8"	64.0	76.0	79.0	22.7	8.8
1-1/2"x1/4"	64.0	76.0	79.0	22.7	11.4
1-1/2"x3/8"	64.0	76.0	79.0	22.7	12.4
1-1/2"x1/2"	64.0	76.0	79.0	22.7	14.9
1-1/2"x3/4"	64.0	76.0	79.0	22.7	16.8
1-1/2"x1"	64.0	76.0	79.0	22.7	19.6
1-1/2"x1-1/4"	64.0	76.0	79.0	22.7	21.9
2"x1/8"	76.0	92.0	86.0	23.9	8.8
2"x1/4"	76.0	92.0	86.0	23.9	11.4
2"x3/8"	76.0	92.0	86.0	23.9	12.4
2"x1/2"	76.0	92.0	86.0	23.9	14.9
2"x3/4"	76.0	92.0	86.0	23.9	16.8
2"x1"	76.0	92.0	86.0	23.9	19.6